



APARTMÁN 4B-L / APARTMENT 4B-L

3 izbový apartmán / 3 rooms apartment

1. vstupná predsieň	/ lobby	0 7 , 5 5 m ²
2. kuchyňa + obyv. izba	/ kitchen + room	2 0 , 1 4 m ²
3. izba	/ room	0 8 , 7 5 m ²
4. spálňa	/ bedroom	0 9 , 1 0 m ²
5. kúpeľňa	/ bathroom	0 2 , 8 1 m ²
6. wc	/ wc	0 1 , 6 2 m ²
7. loggia	/ loggia	0 2 , 9 5 m ²

CELKOVÁ PLOCHA / TOTAL 49,98 m²

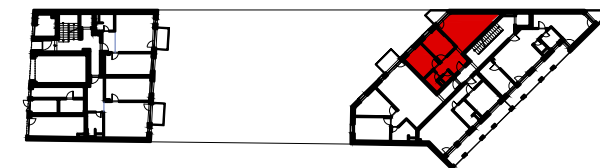
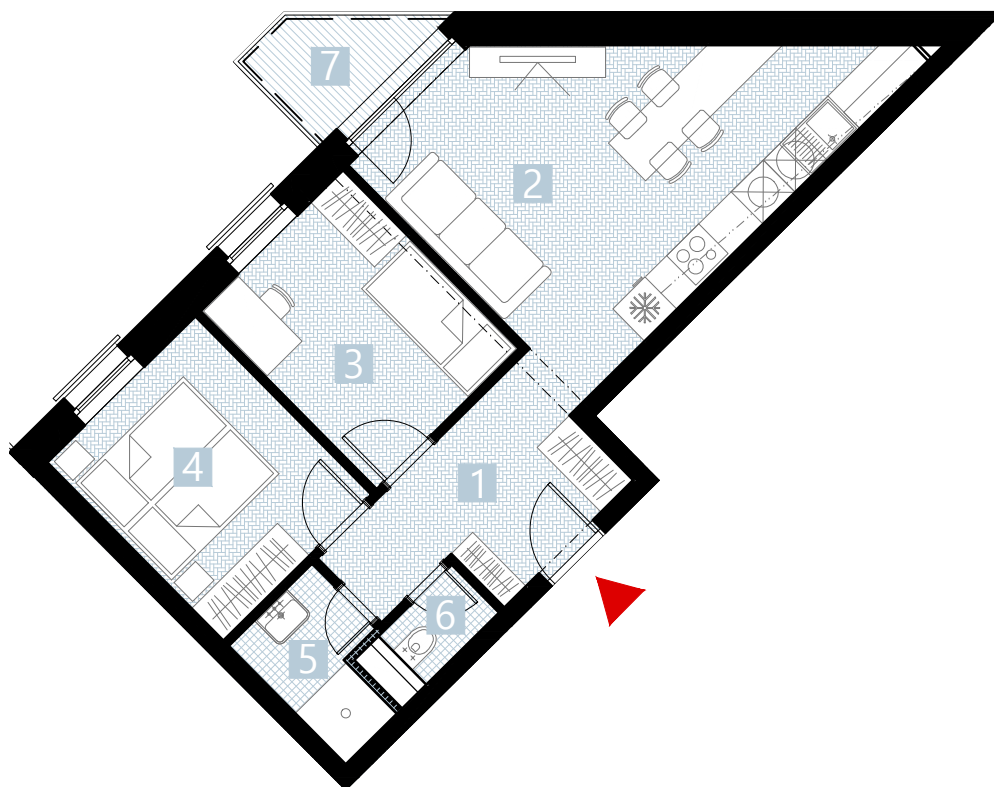

s ch é m a p ô d o r y s u 2 . N P
/ s c h e m e o f t h e s e c o n d f l o o r



s c h é m a t i c n ý r e z o b j e k t o m

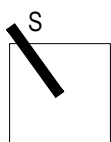

0 1 2 3 4 5 6 M 1:100

I pôdorys je spracovaný na marketingové účely I zariadenie predmety a ich rozmiestnenie má len ilustračný charakter
I floor plan is processed for marketing purposes I furniture and its placement is only for illustration

vigroup

Rohlička 157, 831 07 Bratislava
www.vigroup.sk